

# Accessory Buildings

SAUNAS

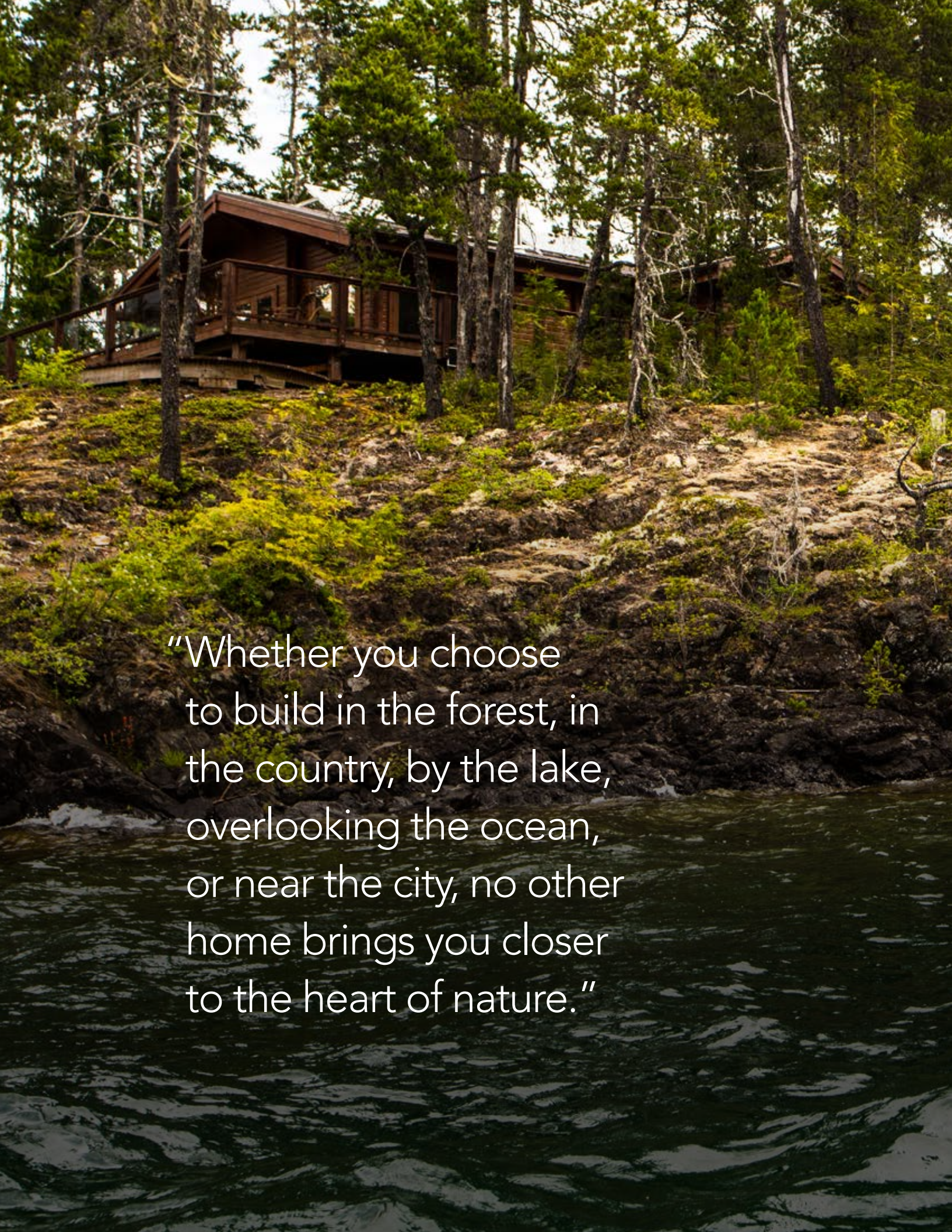

 **pan-abode®**  
THE ORIGINAL

A photograph of a two-story wooden cabin with a balcony, nestled among tall evergreen trees on a steep, mossy hillside. The hillside is covered in green moss and small plants. In the foreground, the dark, rippling water of a lake is visible. The cabin has a dark roof and wooden siding, and its balcony is enclosed with a wooden railing. The trees are tall and thin, with dense green foliage. The overall scene is peaceful and natural.

"Whether you choose  
to build in the forest, in  
the country, by the lake,  
overlooking the ocean,  
or near the city, no other  
home brings you closer  
to the heart of nature."

# Building Original Memories Since 1948



In 1948, Danish master carpenter Aage Jensen had a dream to manufacture Cedar homes out of the abundance of Western Red Cedar that grew on the coasts of the Pacific Northwest. The name Pan-Abode was chosen in tribute to Pan, the Greek god of the wild who was worshipped in natural settings. It was in these fields, groves and wooded glens that everyman could build their retreat away from the pressures and demands of civilization. In the midst of nature's healing environs, one could re-group, re-connect and start over again.

With the aim of making the Pan-Abode dream affordable and buildable by all families, Mr. Jensen drew upon his knowledge of fine carpentry and his deep understanding of the properties of wood to devise the interlocking building system and "lock joint" corners now synonymous with the Pan-Abode name.

During the same 1948 time period, Mr. Jensen teamed up with the brilliant engineer and businessman, Albert "Doc" Steiner. The combined energies of these two remarkable visionaries translated into Pan-Abode homes becoming common features on practically every lakefront throughout North America - thus playing a vital role in the evolution of Cottage Culture on this continent. Additionally, Pan-Abodes were built as summer camps, mining camps, churches, fishing lodges, hotels, motels, restaurants, gas stations and banks, to name but a few of the many applications.

The partnership of Aage Jensen and "Doc" Steiner eventually expanded into a network of dealerships that provided Pan-Abode's unique product across Canada, United States and around the world - including Antarctica.

Today, Pan-Abode International continues to be Canadian-owned and proudly upholds the legacy founded by Aage Jensen and "Doc" Steiner. Our production facility features computerized milling equipment, custom engineered notching machinery, and specialized finishing technology. In our design and engineering offices, we use computerized drafting and log coding software that allows us to provide accurate, detailed drawings and estimates along with superb building site documentation for ease of assembly.

Pan-Abode is committed to staying true to the original vision of its founding partners to provide every family with enduring memories of their "cabin in the woods" experience. As in 1948, our homes continue to be constructed from 100% Western Red Cedar logs, the pristine wood species that has guaranteed comfort, quality and dependability throughout Pan-Abode's long history.

# Sauna Packages

## SINGLE ROOM

2-Person Sauna	35 square feet (3.25 m <sup>2</sup> )
2-3-Person Sauna	48 square feet (4.46 m <sup>2</sup> )
4-Person Sauna	64 square feet (5.95 m <sup>2</sup> )
5-6-Person Sauna	96 square feet (8.92 m <sup>2</sup> )
5-6-Person Sauna	98 square feet (9.10 m <sup>2</sup> )

## DOUBLE ROOM

3-4-Person Sauna	96 square feet (8.92 m <sup>2</sup> )
------------------	---------------------------------------



# Riverton

Pan-Abode's classic two person sauna features our signature solid Western Red Cedar log construction, solid Western Red Cedar door and vaulted roof overhead, providing the ideal personal home spa experience.

Floor Plan:

**Riverton Sauna**

Model No:

**1871**

Total Area:

**35 square feet (3.25 m<sup>2</sup>)**

Width:

**5'-0" (1.53 m)**

Depth:

**7'-0" (2.14 m)**

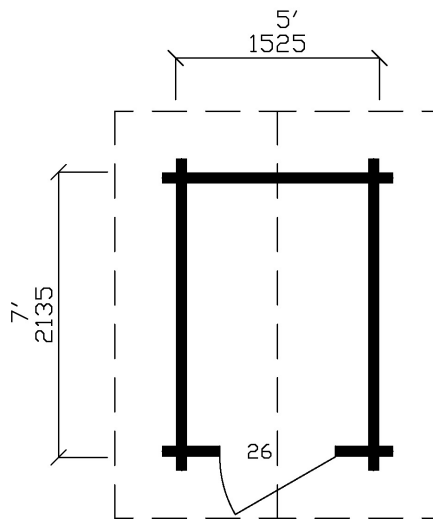

MAIN FLOOR  
**35 square feet (3.25 m<sup>2</sup>)**



12745 - 116 Avenue  
Surrey, BC  
Canada V3V 7H9

**Tel:** 604.582.8295  
**Toll Free:** 1.800.665.0660  
**Fax:** 604.582.9053  
[www.panabode.com](http://www.panabode.com)



# Arborg

Pan-Abode's classic two-three person sauna features our signature solid Western Red Cedar log construction, solid Western Red Cedar door and vaulted roof overhead, providing the ideal aromatic retreat with a bit more lounging space.

Floor Plan:

**Arborg Sauna**

Model No:

**1872**

Total Area:

**48 square feet (4.46 m<sup>2</sup>)**

Width:

**6'-0" (1.83 m)**

Depth:

**8'-0" (2.44 m)**

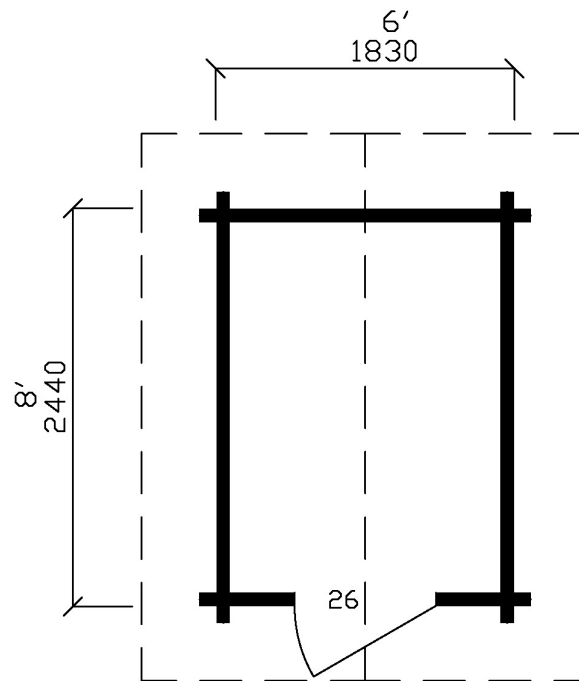

MAIN FLOOR  
**48 square feet (4.46 m<sup>2</sup>)**



# Arnes

For five to six people in a wide layout for three sides suitable for laying down. Like all Pan-Abode saunas, features our solid Cedar log walls, door and vaulted roof overhead with ceiling decking for an enveloping effect. This kit's roof overhang protects you from the elements while entering your western red cedar infused sauna.

Floor Plan:

**Arnes Sauna**

Model No:

**1873**

Total Area:

**96 square feet (8.92 m<sup>2</sup>)**

Width:

**8'-0" (2.44 m)**

Depth:

**12'-0" (3.66 m)**

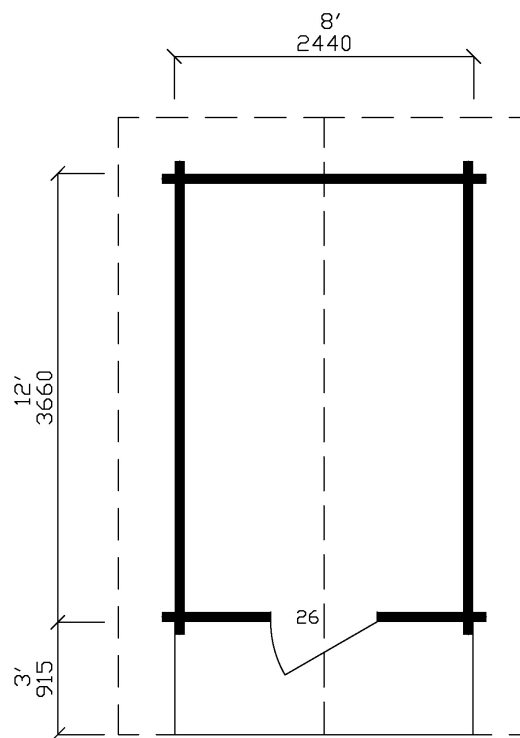

MAIN FLOOR  
**96 square feet (8.92 m<sup>2</sup>)**



# Hecla

A five to six person sauna in a long layout suitable for roomy seating or laying down. Features our signature solid Western Red Cedar log construction, solid Cedar door and vaulted roof overhead with Cedar ceiling decking to be wrapped in cedar. This style includes a deep roof overhang to protect you from the elements while entering your sauna.

Floor Plan:

## Hecla Sauna

Model No:

**1874**

Total Area:

**98 square feet (9.10 m<sup>2</sup>)**

Width:

**7'-0" (2.135 m)**

Depth:

**14'-0" (4.27 m)**

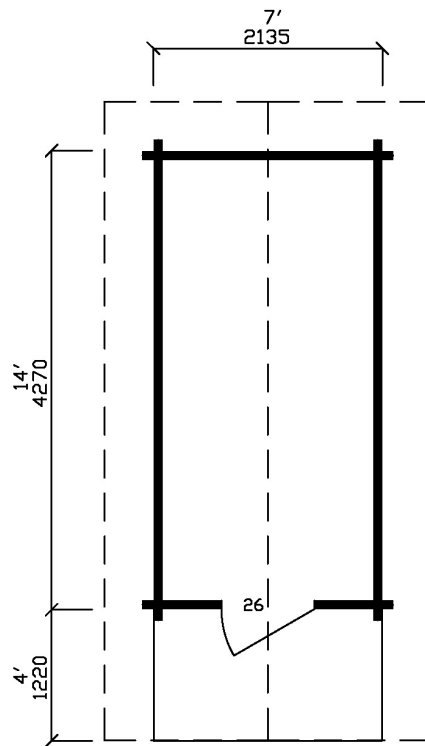

MAIN FLOOR  
**98 square feet (9.10 m<sup>2</sup>)**



# Gimli

Room enough for three to four people in the sauna and with a double room to change and prepare for your cedar sauna experience. This style includes an extra deep roof overhang to protect you from the elements. With the extra deep entrance and interior change room, this design is especially delightful on those long winter days when only a sauna will get you fully warmed up.

Floor Plan:

## Gimli Sauna

Model No:

**1875**

Total Area:

**96 square feet (8.92 m<sup>2</sup>)**

Width:

**8'-0" (2.44 m)**

Depth:

**12'-0" (3.66 m)**

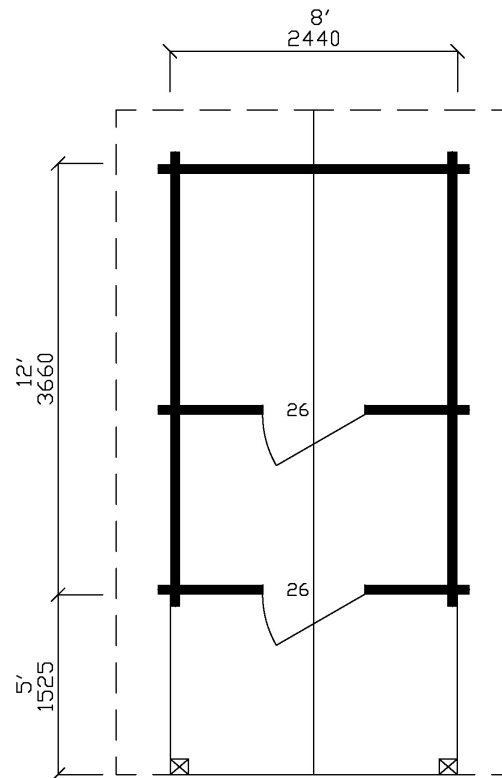

MAIN FLOOR  
**96 square feet (8.92 m<sup>2</sup>)**

# Package Contents

● INCLUDED IN BASE PACKAGE

○ OPTIONAL ADDITION

N/A NOT APPLICABLE

ITEM	MATERIALS	SAUNA	SAUNA WITH CHANGE ROOM
<b>MAIN FLOOR</b>			
FLOOR SYSTEM	2"x 8" Kiln Dried SPF for constructing joist support beams, 2"x 8" Kiln Dried SPF floor joists as required, and 5/8" Tongue & Groove Spruce plywood subfloor (underlay grade)	●	●
EXTERIOR WALLS	Select grade Western Red Cedar 4"x 6" Double Tongue & Groove Pan-Abode logs notched to form Pan-Abode's patented "lock joint" at all intersecting points	●	●
INTERIOR WALLS	Select grade Western Red Cedar 4"x 6" Double Tongue & Groove Pan-Abode logs as above	N/A	●
<b>CEILING AND ROOF</b>			
PURLINS	Douglas Fir glued-laminated beams individually sized for roof load requirements up to 60 psf ground snow load. Higher loads can be accommodated subject to additional charges.	●	●
CEILING FINISH / SOFFIT	2"x 6" Tongue & Groove Western Red Cedar Select grade decking V-Jointed on face side (Selected lengths)	●	●
FRAME ROOF SYSTEM	2"x 12" Kiln Dried SPF roof rafters at 24" on center to Building Code requirements and eave venting. 1/2" Spruce plywood roof sheathing and H-Clips. R-28 batts and approved vapor barrier.	○	○
ASPHALT ROOF	Asphalt shingles (25 year warranty), ridge cap and roof venting.	●	●
METAL ROOF	Upgrade to Metal Roofing (40 year warranty), ridge cap and roof venting.	○	○
<b>DOORS</b>	<b>Complete with hardware, pre-hung in frames.</b>		
EXTERIOR DOOR	1-3/4" Solid Western Red Cedar and Half Glass Sauna Door. Factory weather-stripped with sill. Complete with wooden handles, stainless steel hinges and ball catch latch.	●	●
INTERIOR DOOR	Solid Cedar door with sauna hardware.	N/A	●
<b>OTHER</b>			
INTERIOR TRIM	Pre-mitred casing to complete installation of door frames. Quarter round for finishing all joints between roof and logs.	●	●
EXTERIOR TRIM	Western Red Cedar base trim, fascia/barge boards	●	●
MISCELLANEOUS	All required common, finishing and roofing nails. Packing for use around exterior door and caulking for use between logs and stub ends. Flashing for heads of door in gable walls. Complete blueprints, log coding, material list, nylon hammer block, 5m (16') tape measure, and Construction Manual.	●	●





12745 - 116 Avenue  
Surrey, BC  
Canada V3V 7H9

**Tel:** 604.582.8295  
**Toll Free:** 1.800.665.0660  
**Fax:** 604.582.9053  
[www.panabode.com](http://www.panabode.com)