

Classic Series

RANCHERS | LOFTS & TWO STOREY

 **pan-abode®**
THE ORIGINAL



The Original



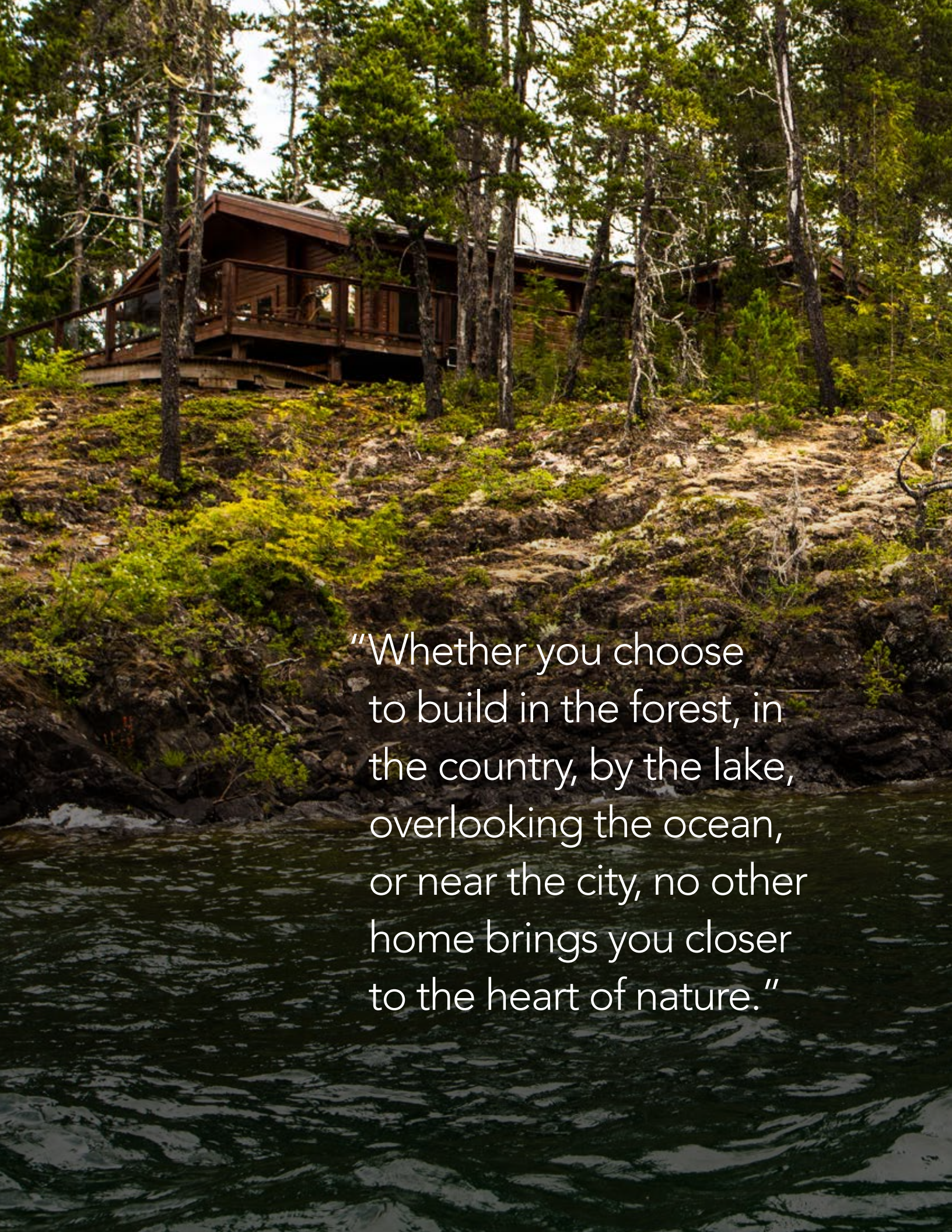

"Whether you choose to build in the forest, in the country, by the lake, overlooking the ocean, or near the city, no other home brings you closer to the heart of nature."

Why a Pan-Abode?

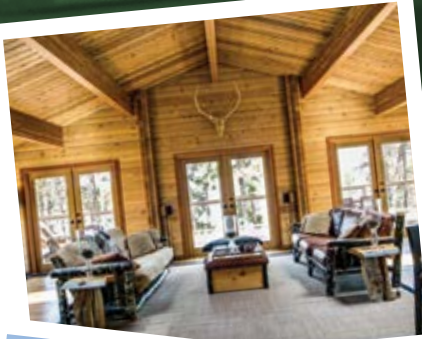

Whether you choose to build in the forest, in the country, by the lake, overlooking the ocean, or near the city, no other home brings you closer to the heart of nature.

The difference, quite simply, is Western Red Cedar - a unique variety of wood species common only to North America's Pacific Northwest.

Our indigenous peoples long ago recognized the sacredness of Red Cedar, which they referred to as the "Tree of Life" - as it sustained the mind, body and soul. It is the innate attributes of Western Red Cedar transformed into your Pan-Abode home that make all the difference. They combine to create a living environment that is warm and harmonious while providing dependability and endurance... It is the cedar that connects us to nature.

Flexible, Affordable, and Innovative

We have been designing your homes and building your memories since 1948... a long history that testifies to the enduring Pan-Abode Experience.

Pan-Abode's proven home packages and custom home design provide our customers with a building system that's both flexible and affordable.

If You Can Dream It, We Can Build It

Choose one of our standard floor plans - or use them as inspiration to customize a design that is unique for you.

Our standard home packages contain all materials needed to reach the "lock up" stage of construction - including the floor system, walls, doors, windows, ceiling, and roof system.

***"You won't find a home
that's easier to assemble."***

Building Original Memories Since 1948



In 1948, Danish master carpenter Aage Jensen had a dream to manufacture Cedar homes out of the abundance of Western Red Cedar that grew on the coasts of the Pacific Northwest. The name Pan-Abode was chosen in tribute to Pan, the Greek god of the wild who was worshipped in natural settings. It was in these fields, groves and wooded glens that everyman could build their retreat away from the pressures and demands of civilization. In the midst of nature's healing environs, one could re-group, re-connect and start over again.

With the aim of making the Pan-Abode dream affordable and buildable by all families, Mr. Jensen drew upon his knowledge of fine carpentry and his deep understanding of the properties of wood to devise the interlocking building system and "lock joint" corners now synonymous with the Pan-Abode name.

During the same 1948 time period, Mr. Jensen teamed up with the brilliant engineer and businessman, Albert "Doc" Steiner. The combined energies of these two remarkable visionaries translated into Pan-Abode homes becoming common features on practically every lakefront throughout North America - thus playing a vital role in the evolution of Cottage Culture on this continent. Additionally, Pan-Abodes were built as summer camps, mining camps, churches, fishing lodges, hotels, motels, restaurants, gas stations and banks, to name but a few of the many applications.

The partnership of Aage Jensen and "Doc" Steiner eventually expanded into a network of dealerships that provided Pan-Abode's unique product across Canada, United States and around the world - including Antarctica.

Today, Pan-Abode International continues to be Canadian-owned and proudly upholds the legacy founded by Aage Jensen and "Doc" Steiner. Our production facility features computerized milling equipment, custom engineered notching machinery, and specialized finishing technology. In our design and engineering offices, we use computerized drafting and log coding software that allows us to provide accurate, detailed drawings and estimates along with superb building site documentation for ease of assembly.

Pan-Abode is committed to staying true to the original vision of its founding partners to provide every family with enduring memories of their "cabin in the woods" experience. As in 1948, our homes continue to be constructed from 100% Western Red Cedar logs, the pristine wood species that has guaranteed comfort, quality and dependability throughout Pan-Abode's long history.

Classic Series

RANCHERS

| | |
|----------|--|
| Teton | 292 square feet (27.16 m ²) |
| Quadra | 589 square feet (54.68 m ²) |
| Shasta | 792 square feet (73.55 m ²) |
| Galiano | 931 square feet (86.5 m ²) |
| Gabriola | 990 square feet (91.95 m ²) |
| Paisley | 1,152 square feet (107.03 m ²) |
| Lakewood | 1,696 square feet (157.54 m ²) |
| Denman | 1,735 square feet (161.21 m ²) |
| Saturna | 2,170 square feet (201.61 m ²) |

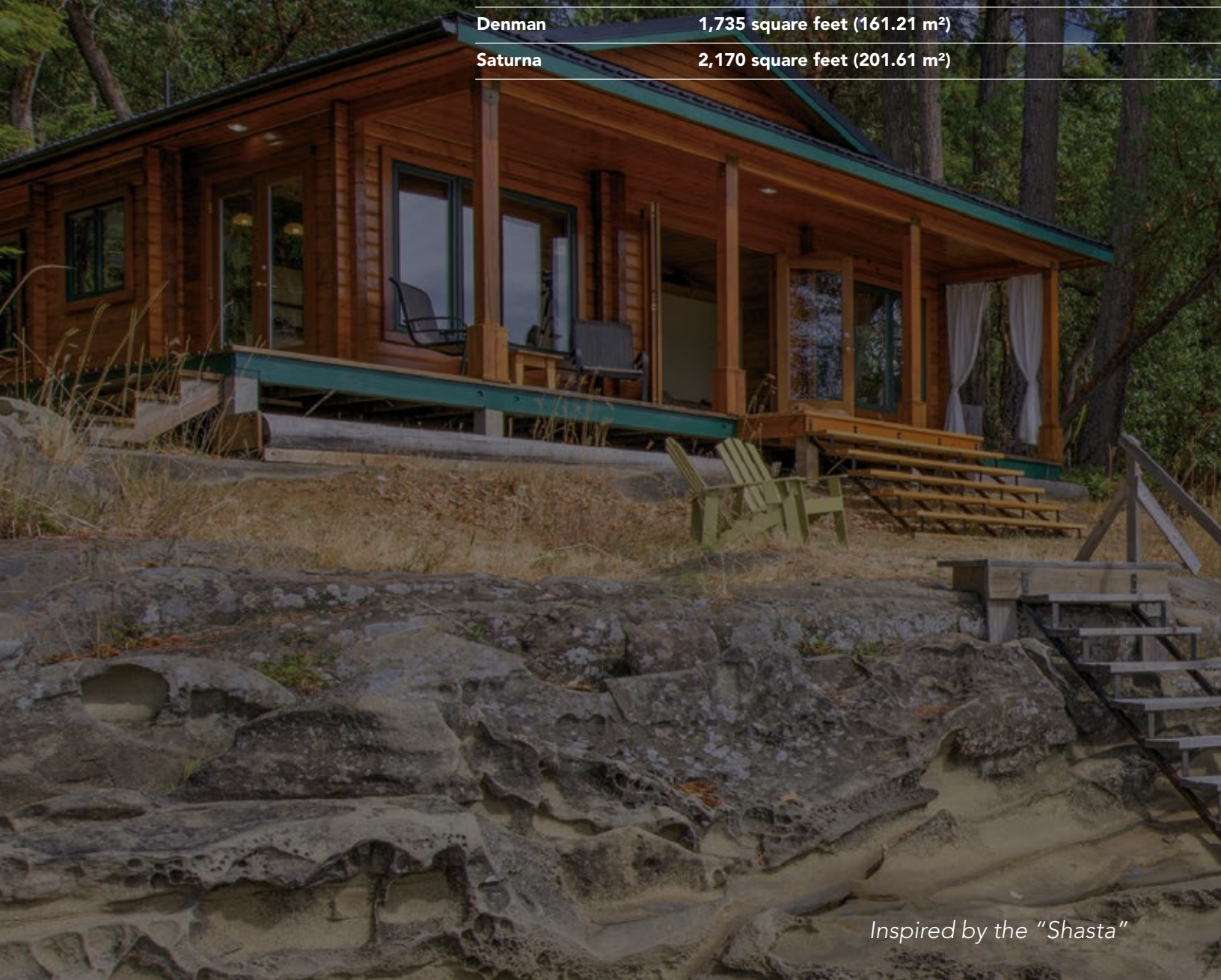

Inspired by the "Shasta"



Teton

A tiny outdoor retreat in complete harmony with its environment. Imagine the warm rich coppery hues emanating from the solid Western Red Cedar walls. Throw another log in your airtight stove. Complete with kitchen and bathroom. No home could be cozier or more efficient.

Floor Plan:

Teton

Model No:

721

Total Area:

292 square feet (27.16 m²)

Width:

18'-1" (5.52 m)

Depth:

16'-2" (4.92 m)

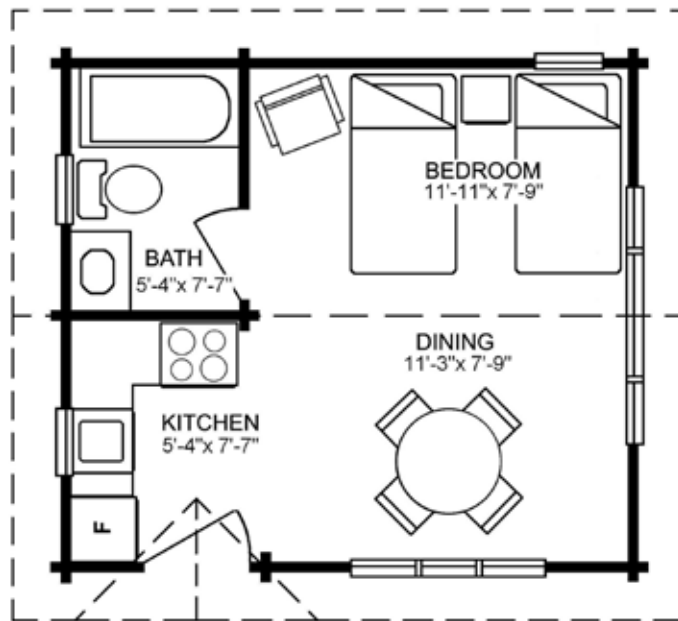

MAIN FLOOR
292 square feet (27.16 m²)



Quadra

This cozy and comfortable home makes roughing it a positively pleasurable experience. Two bedrooms with a shared bathroom complement an open kitchen, dining and living area. The large picture windows add a stunning sense of space to this charming model.

Floor Plan:

Quadra

Model No:

292

Total Area:

589 square feet (54.68 m²)

Width:

24'-1" (7.35 m)

Depth:

25'-9" (7.84 m)

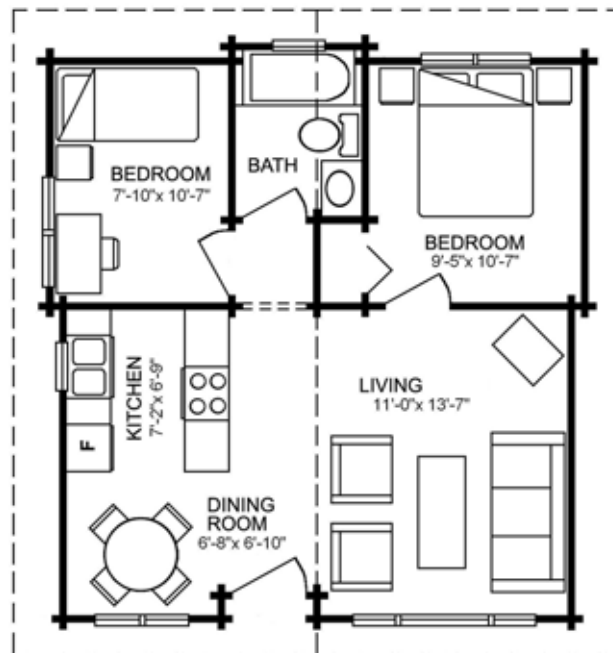

MAIN FLOOR
589 square feet (54.68 m²)



Shasta

The distinctive Dutch style roof shelters a compact yet highly livable home. The exterior walls exude the warmth of Pan-Abode's signature Western Red Cedar logs while the interior walls are framed and clad with your choice of log siding or drywall to provide contrast and brightness. The large glass areas and sliding glass door make this spacious plan in tune with the outdoors.

Floor Plan:

Shasta

Model No:

3250

Total Area:

792 square feet (73.55 m²)

Width:

31'-3" (9.51 m)

Depth:

27'-3" (8.29 m)

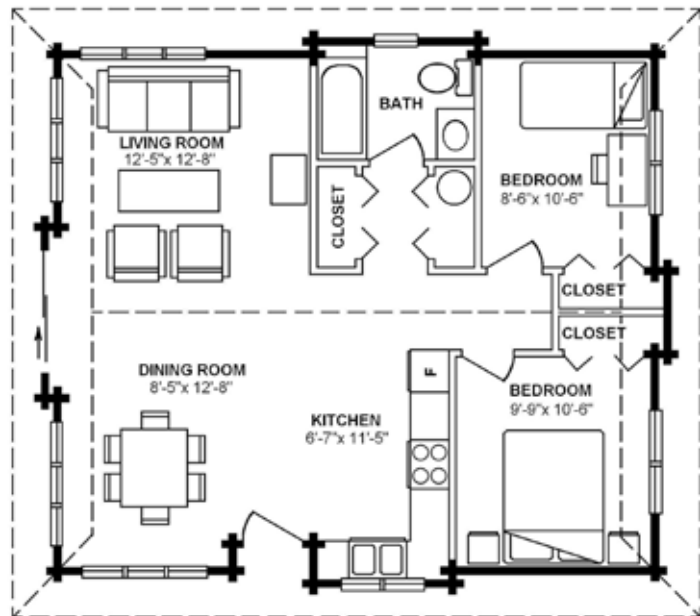

MAIN FLOOR
792 square feet (73.55 m²)



Galiano

The comforts and conveniences of cottage life are perfectly featured in this well-planned home. Exposed wood beams and vaulted ceilings highlight a floor plan that includes an open kitchen/dining/living room area, a sizeable utility room, two bedrooms and a fully appointed bathroom. A covered porch provides the perfect setting for outdoor entertainment.

Floor Plan:

Galiano

Model No:

5080

Total Area:

931 square feet (86.5 m²)

Width:

30'-2" (9.2 m)

Depth:

34'-6" (10.5 m)

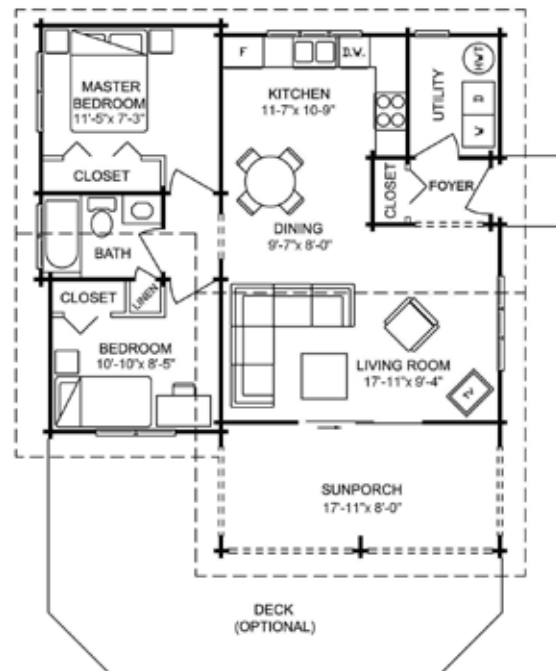

MAIN FLOOR
931 square feet (86.5 m²)



Gabriola

This spacious two bedroom premium vacation home features vast expanses of glass and a classic "T" shape that naturally lends itself to panoramic views from surrounding decks. Low maintenance Western Red Cedar means more relaxing while you're in your vacation retreat.

Floor Plan:

Gabriola

Model No:

1550

Total Area:

990 square feet (91.95 m²)

Width:

39'-9" (12.11 m)

Depth:

33'-0" (10.0 m)

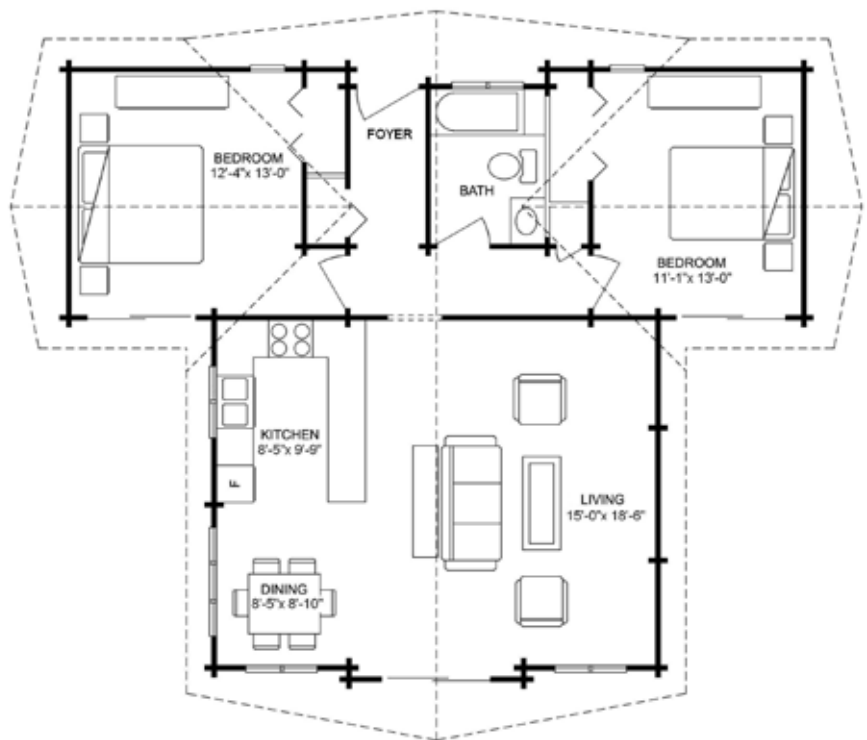

MAIN FLOOR
990 square feet (91.95 m²)



Paisley

Featuring three bedrooms and a good sized utility room, this Pan-Abode rancher is perfect for the recreational property owner. Sliding glass doors provide easy access from the bedrooms to the optional wrap around cedar decks. The kitchen, dining and family rooms are arranged together in a modern open design concept.

Floor Plan:

Paisley

Model No:

1555

Total Area:

1,152 square feet (107.03 m²)

Width:

42'-9" (13.03 m)

Depth:

35'-2" (10.72 m)

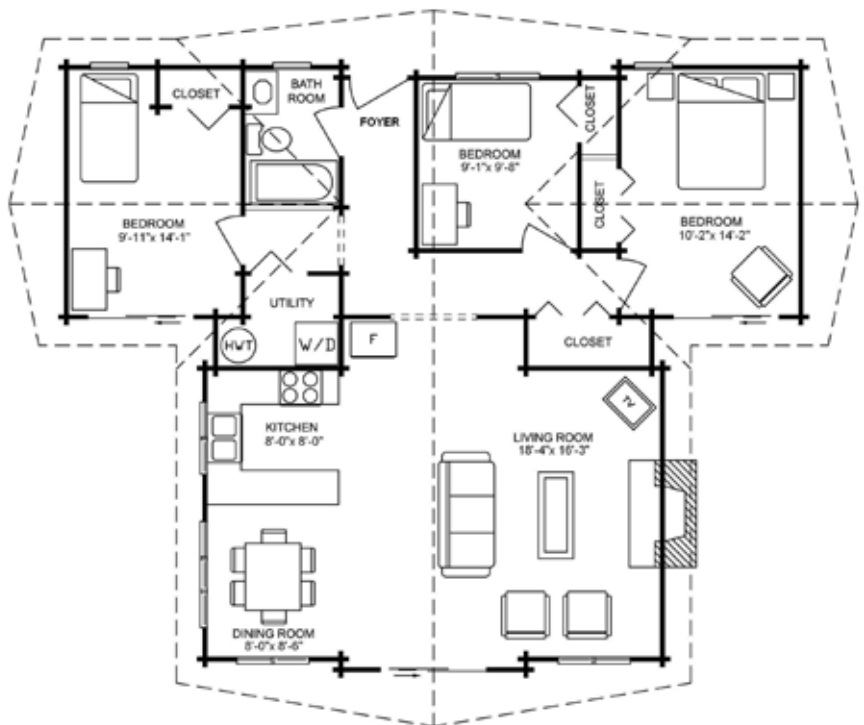

MAIN FLOOR
1,152 square feet (107.03 m²)



Lakewood

A fabulous home for entertaining with an open plan encompassing dining room, family room and living room all around a unique central fireplace. The Master Bedroom includes a walk-in closet, bathroom and powder room. The Lakewood is a perfect home for gatherings with family and friends.

Floor Plan:

Lakewood

Model No:

1580

Total Area:

1,696 square feet (157.54 m²)

Width:

63'-0" (19.2 m)

Depth:

34'-5" (10.5 m)

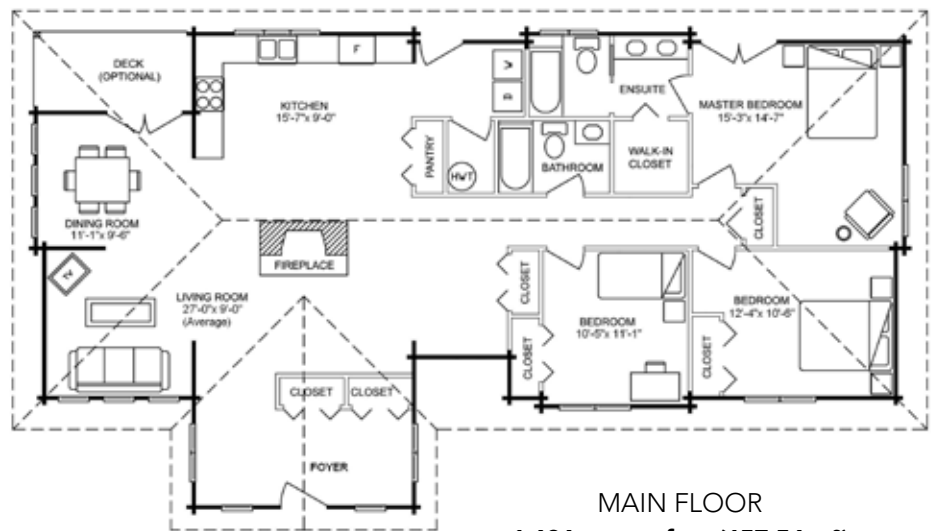

MAIN FLOOR
1,696 square feet (157.54 m²)



Denman

The Denman offers an exciting hexagonal floor plan with expansive Great Room encompassing kitchen, dining and living areas under a vaulted open beam cathedral ceiling, surrounded by glass and centered on an open fireplace. Wings on either side of the Great Room contain a Master Bedroom with bathroom and a two bedroom plus bathroom combination respectively.

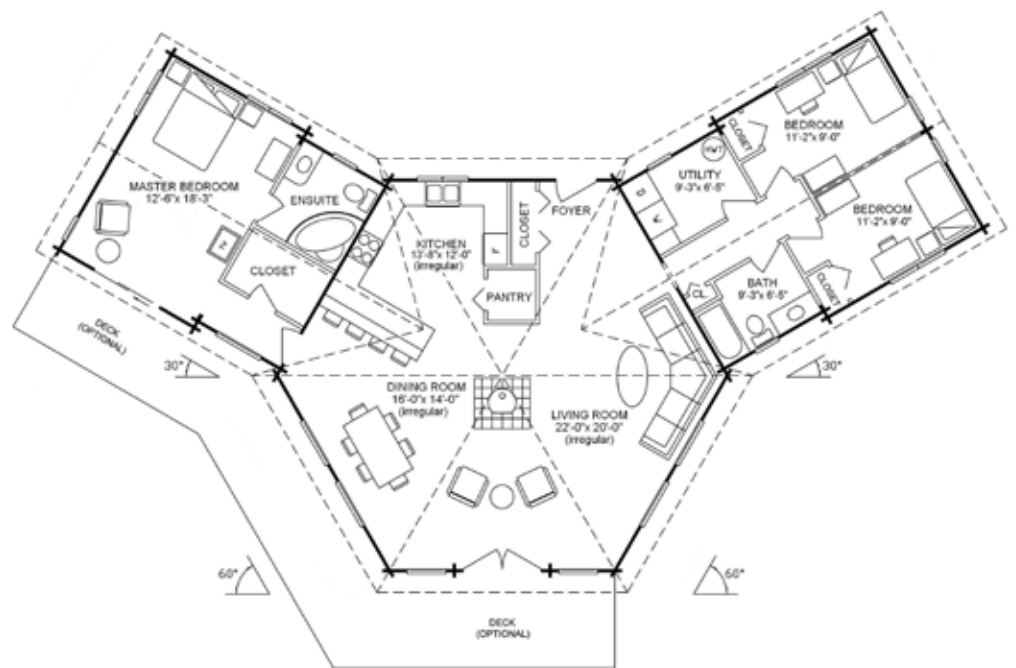

MAIN FLOOR
1,735 square feet (161.21 m²)

Floor Plan:

Denman

Model No:

5817

Total Area:

1,735 square feet (161.21 m²)

Width:

77'-0" (23.49 m)

Depth:

45'-3" (13.8 m)



12745 - 116 Avenue
Surrey, BC
Canada V3V 7H9

Tel: 604.582.8295
Toll Free: 1.800.665.0660
Fax: 604.582.9053
www.panabode.com



Saturna

A stunning plan featuring vaulted ceilings in the living and dining rooms, expansive glass, three bedrooms, two bathrooms plus an open family room and kitchen with adjoining breakfast nook. This is a very roomy home with a large deck that is perfect for a view property. Note the French doors opening off both the Family Room and Master Bedroom.

Floor Plan:

Saturna

Model No:

5814

Total Area:

2,170 square feet (201.61 m²)

Width:

62'-1" (18.93 m)

Depth:

46'-1" (14.0 m)

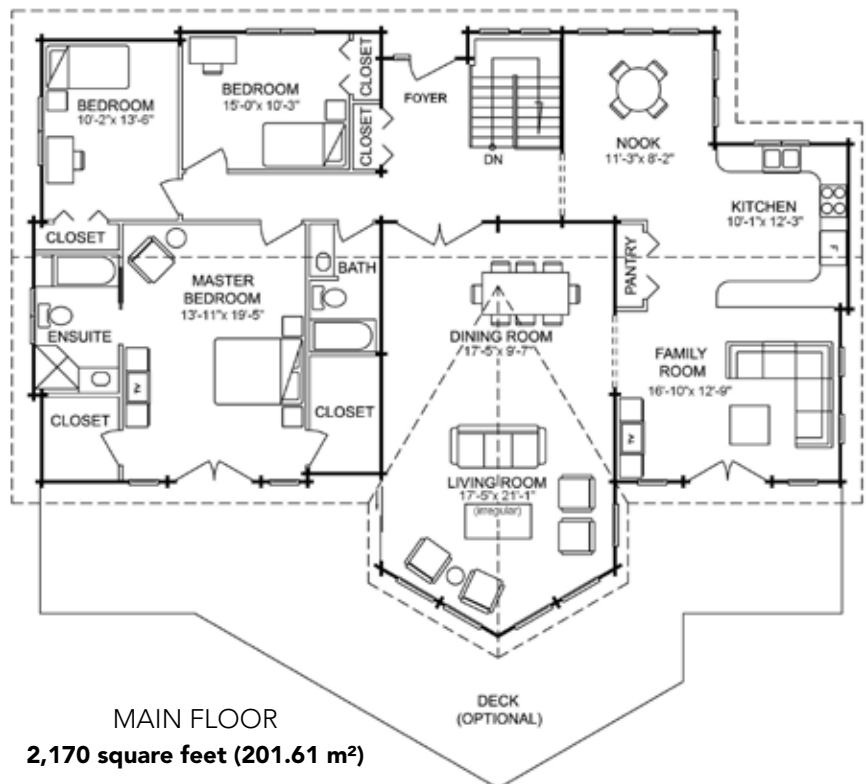

Classic Series

LOFTS & TWO STOREY

| | |
|----------|--|
| Muskoka | 733 square feet (68.14 m ²) |
| Shuswap | 940 square feet (87.36 m ²) |
| Phoenix | 1,258 square feet (116.87 m ²) |
| Aleutian | 1,286 square feet (119.47 m ²) |
| Yosemite | 1,615 square feet (150.07 m ²) |
| Montana | 2,243 square feet (208.37 m ²) |
| Vermont | 2,329 square feet (216.33 m ²) |

Inspired by the "Yosemite"



Muskoka

The perfect mountain retreat. This simple and highly functional plan features the Master Bedroom and Great Room on the main floor, while the loft accommodates guests or the kids. And of course it's a low maintenance Pan-Abode made from solid Western Red Cedar logs, so you'll spend more time relaxing and enjoying peace of mind with this compact and attractive model.

Floor Plan:

Muskoka

Model No:

1450

Total Area:

733 square feet (68.14 m²)

Width:

21'-6" (6.56 m)

Depth:

26'-11" (8.2 m)

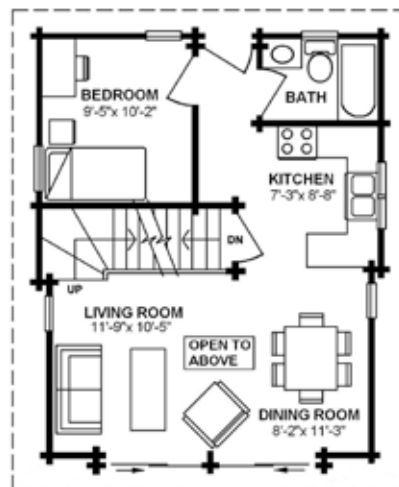

MAIN FLOOR

559 square feet (51.93 m²)

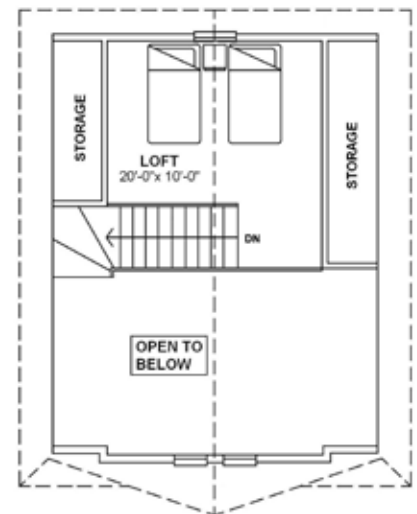

LOFT

174 square feet (16.21 m²)



Shuswap

This highly functional floor plan leaves no wasted space. The Shuswap features two loft areas, a large vaulted Great Room and a spacious Master Bedroom with an adjoining bathroom. Relax with the family in your getaway cottage - ideal for any location.

Floor Plan:

Shuswap

Model No:

8865

Total Area:

940 square feet (87.36 m²)

Width:

19'-4" (5.90 m)

Depth:

36'-4" (11.07 m)



MAIN FLOOR

531 square feet (49.29 m²)

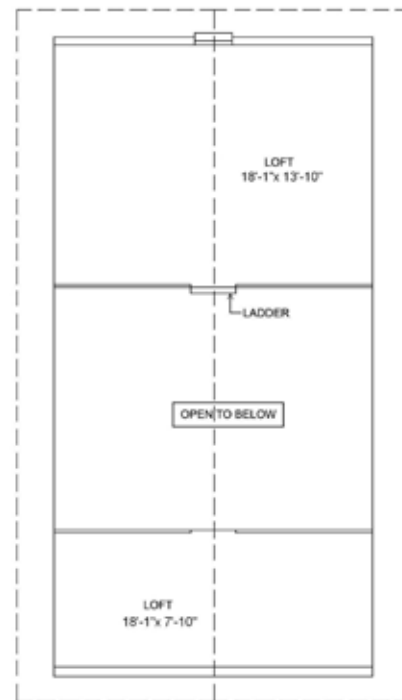

LOFT

409 square feet (38.07 m²)



Phoenix

Perfect for a family vacation retreat or primary residence, the Phoenix has it all. This floor plan features three spacious bedrooms with two full bathrooms and an open living area that combines kitchen, living and dining rooms. Relax and enjoy the view from your private covered balcony that extends off the Master Bedroom. Optional front decking completes this gem.

Floor Plan:

Phoenix

Model No:

5060

Total Area:

1,258 square feet (116.87 m²)

Width:

26'-3" (8.0 m)

Depth:

36'-0" (11.0 m)

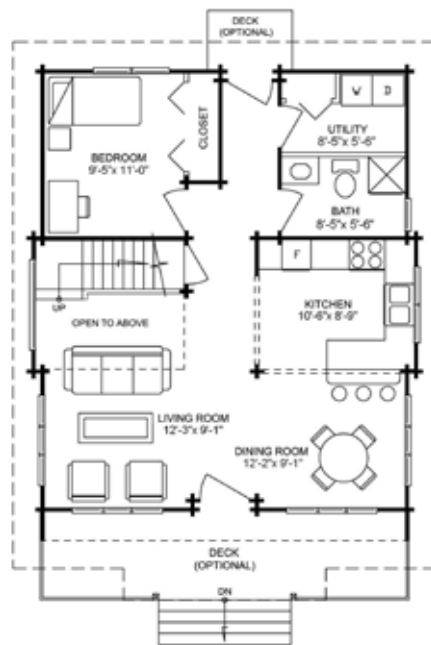

MAIN FLOOR
757 square feet (70.30 m²)

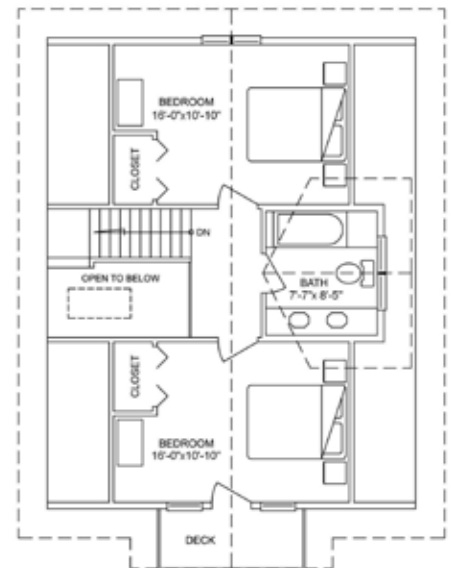

UPPER FLOOR
501 square feet (46.57 m²)



Aleutian

The Aleutian's covered front entranceway leads to a bright airy vacation retreat with vaulted ceilings over an expansive Great Room. It's the perfect home for ocean and lakeside locations or any property with a spectacular view.

Floor Plan:

Aleutian

Model No:

1470

Total Area:

1,286 square feet (119.47 m²)

Width:

29'-6" (8.99 m)

Depth:

35'-11" (10.95 m)

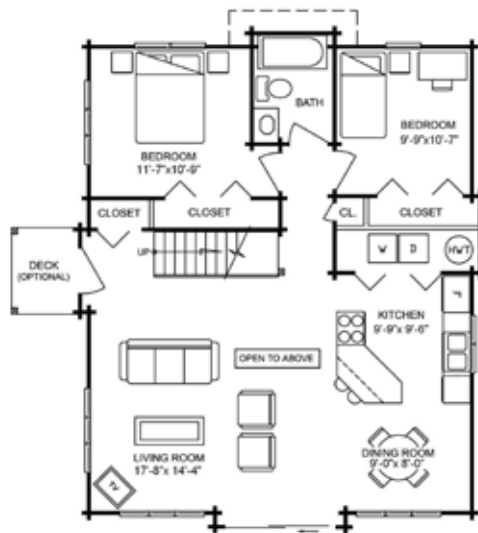

MAIN FLOOR
993 square feet (92.25 m²)

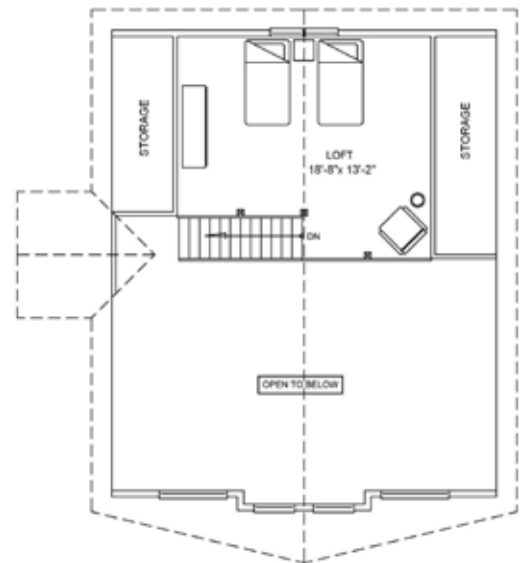

LOFT
293 square feet (27.22 m²)



Yosemite

Traditional, sweeping prow styling, vaulted ceilings and an extremely efficient floor plan help make the Yosemite a perennial favorite. Featuring optional decking and a spacious Master Bedroom on the upper level with a walk-in closet and bathroom.

Floor Plan:

Yosemite

Model No:

4328

Total Area:

1,615 square feet (150.07 m²)

Width:

28'-0" (8.55 m)

Depth:

39'-9" (12.12 m)

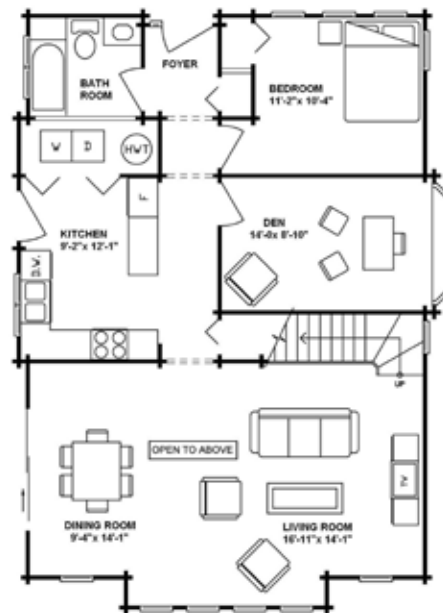

MAIN FLOOR

1,053 square feet (97.85 m²)

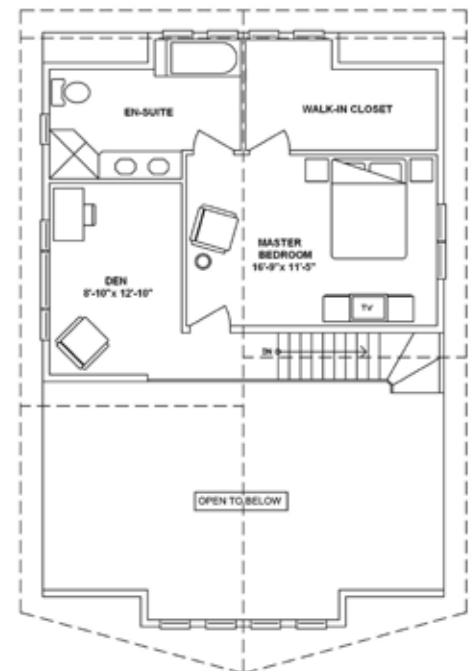

UPPER FLOOR

562 square feet (52.22 m²)



Montana

This spacious four-bedroom, two and a half bathroom floor plan features nine-foot ceilings throughout, an open design which includes vaulted ceilings in the Great Room and an oversized kitchen area with pantry. Its large size and open concept make it the perfect family home or vacation getaway to be shared with your friends.

Floor Plan:

Montana

Model No:

5020

Total Area:

2,243 square feet (208.37 m²)

Width:

52'-6" (16.0 m)

Depth:

39'-4" (12.0 m)

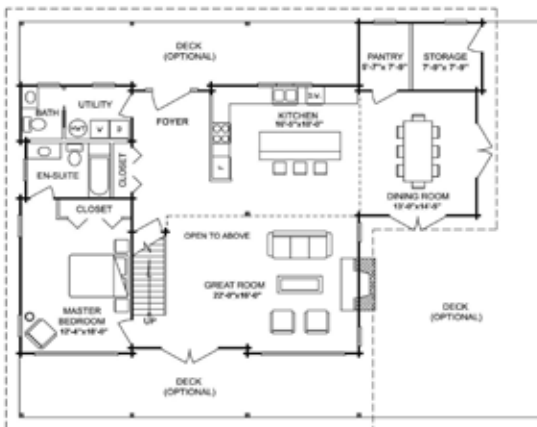

MAIN FLOOR
1,529 square feet (142.06 m²)

UPPER FLOOR
714 square feet (66.31 m²)

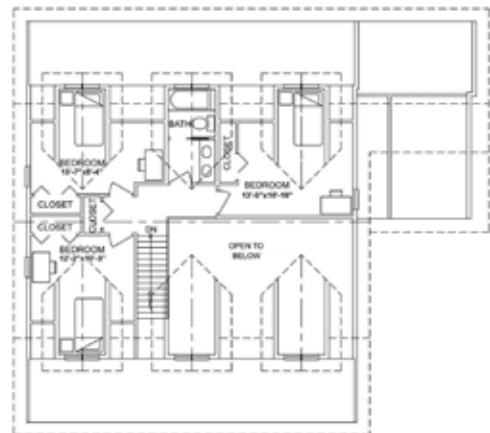



Vermont

An elegant home distinguished by vast areas of glass and expansive decks. The spacious gourmet kitchen features a large eating nook and Family Room. The Master Bedroom includes a bathroom and walk-in closet with French doors leading onto a deck or garden setting. Formal living and dining rooms, two bedrooms on the upper level and a grand entrance make the Vermont a spectacular place to call home.

Floor Plan:

Vermont

Model No:

2001

Total Area:

2,329 square feet (216.33 m²)

Width:

57'-8" (17.57 m)

Depth:

41'-6" (12.65 m)

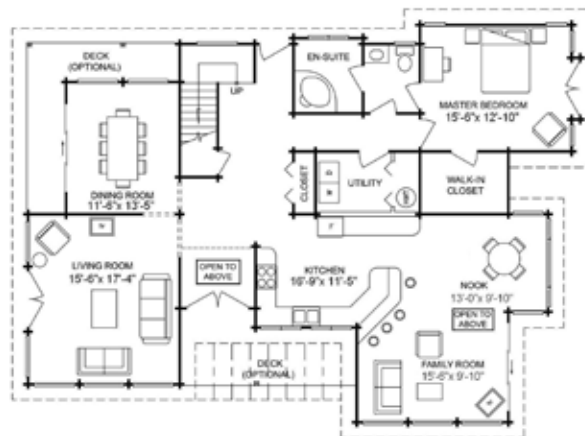

MAIN FLOOR
1,771 square feet (164.51 m²)

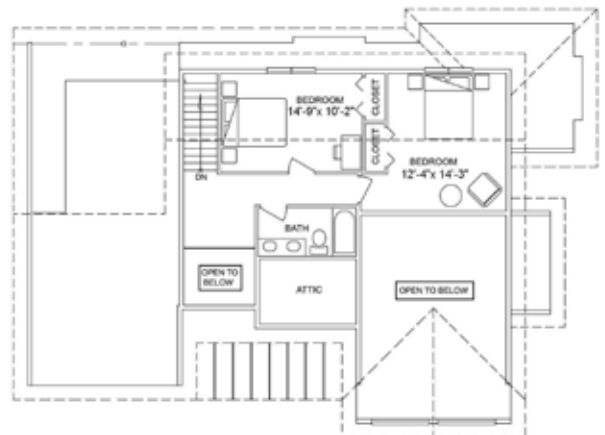

UPPER FLOOR
558 square feet (51.82 m²)



Inspired by the "Phoenix"



The Original





12745 - 116 Avenue
Surrey, BC
Canada V3V 7H9

Tel: 604.582.8295
Toll Free: 1.800.665.0660
Fax: 604.582.9053
www.panabode.com