



Arnes

For five to six people in a wide layout for three sides suitable for laying down. Like all Pan-Abode saunas, features our solid Cedar log walls, door and vaulted roof overhead with ceiling decking for an enveloping effect. This kit's roof overhang protects you from the elements while entering your western red cedar infused sauna.

Floor Plan:

Arnes Sauna

Model No:

1873

Total Area:

96 square feet (8.92 m²)

Width:

8'-0" (2.44 m)

Depth:

12'-0" (3.66 m)

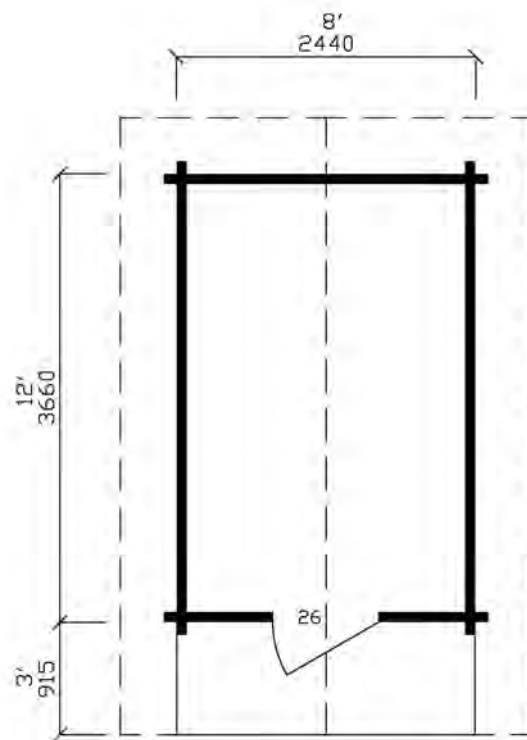

MAIN FLOOR
96 square feet (8.92 m²)