



# Muskoka

The perfect mountain retreat. This simple and highly functional plan features the Master Bedroom and Great Room on the main floor, while the loft accommodates guests or the kids. And of course it's a low maintenance Pan-Abode made from solid Western Red Cedar logs, so you'll spend more time relaxing and enjoying peace of mind with this compact and attractive model.

Floor Plan:

**Muskoka**

Model No:

**1450**

Total Area:

**733 square feet (68.14 m<sup>2</sup>)**

Width:

**21'-6" (6.56 m)**

Depth:

**26'-11" (8.2 m)**

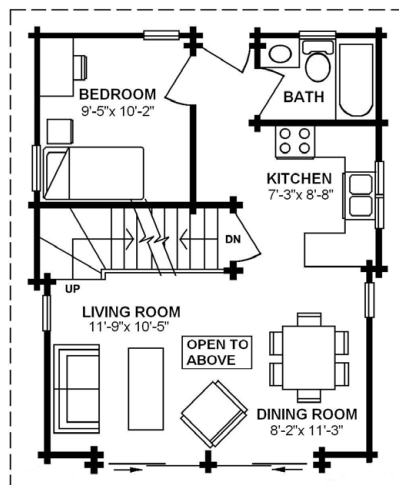

MAIN FLOOR

**559 square feet (51.93 m<sup>2</sup>)**

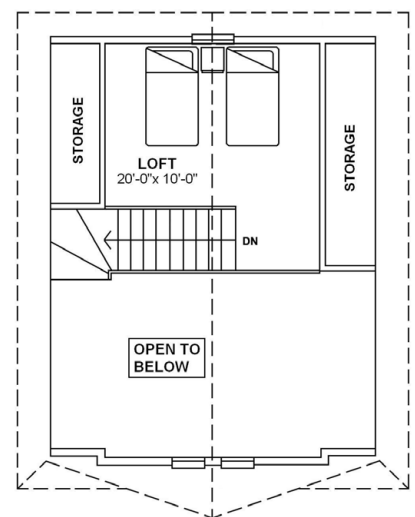

LOFT

**174 square feet (16.21 m<sup>2</sup>)**



12745 - 116 Avenue  
Surrey, BC  
Canada V3V 7H9

Tel: 604.582.8295  
Toll Free: 1.800.665.0660  
Fax: 604.582.9053  
www.panabode.com