



Galiano

The comforts and conveniences of cottage life are perfectly featured in this well-planned home. Exposed wood beams and vaulted ceilings highlight a floor plan that includes an open kitchen/dining/living room area, a sizeable utility room, two bedrooms and a fully appointed bathroom. A covered porch provides the perfect setting for outdoor entertainment.

Floor Plan:

Galiano

Model No:

5080

Total Area:

931 square feet (86.5 m²)

Width:

30'-2" (9.2 m)

Depth:

34'-6" (10.5 m)

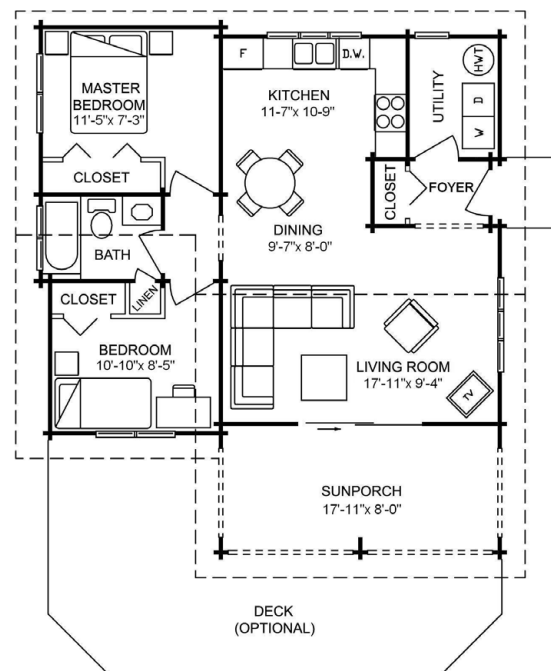

MAIN FLOOR
931 square feet (86.5 m²)