



Denman

The Denman offers an exciting hexagonal floor plan with expansive Great Room encompassing kitchen, dining and living areas under a vaulted open beam cathedral ceiling, surrounded by glass and centered on an open fireplace. Wings on either side of the Great Room contain a Master Bedroom with bathroom and a two bedroom plus bathroom combination respectively.

Floor Plan:

Denman

Model No:

5817

Total Area:

1,735 square feet (161.21 m²)

Width:

77'-0" (23.49 m)

Depth:

45'-3" (13.8 m)

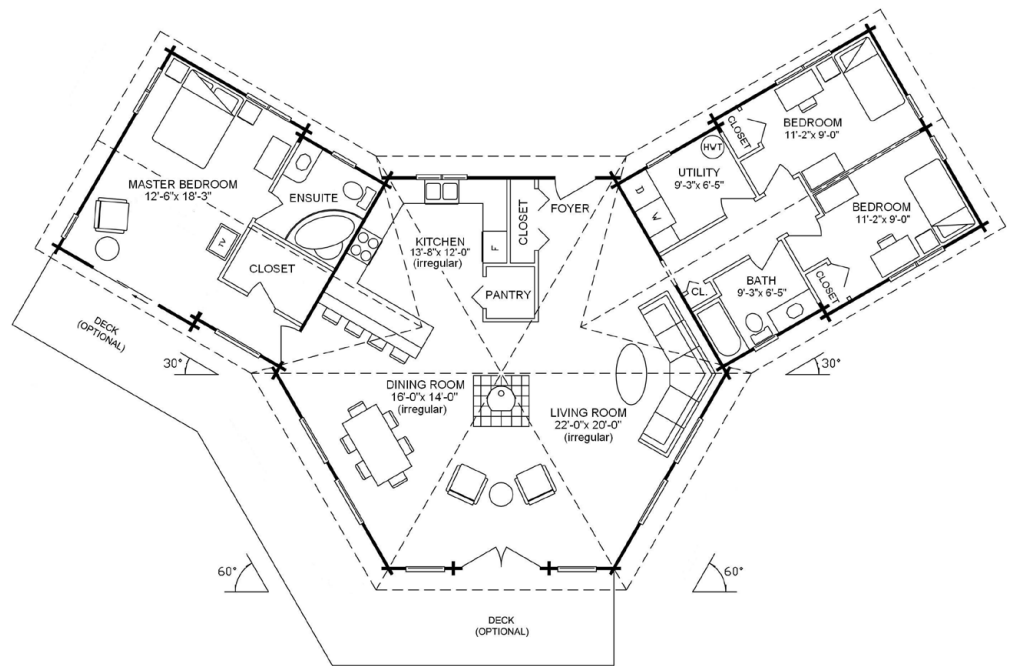

MAIN FLOOR
1,735 square feet (161.21 m²)



12745 - 116 Avenue
Surrey, BC
Canada V3V 7H9

Tel: 604.582.8295
Toll Free: 1.800.665.0660
Fax: 604.582.9053
www.panabode.com