



Lakewood

A fabulous home for entertaining with an open plan encompassing dining room, family room and living room all around a unique central fireplace. The Master Bedroom includes a walk-in closet, bathroom and powder room. The Lakewood is a perfect home for gatherings with family and friends.

Floor Plan:

Lakewood

Model No:

1580

Total Area:

1,696 square feet (157.54 m²)

Width:

63'-0" (19.2 m)

Depth:

34'-5" (10.5 m)

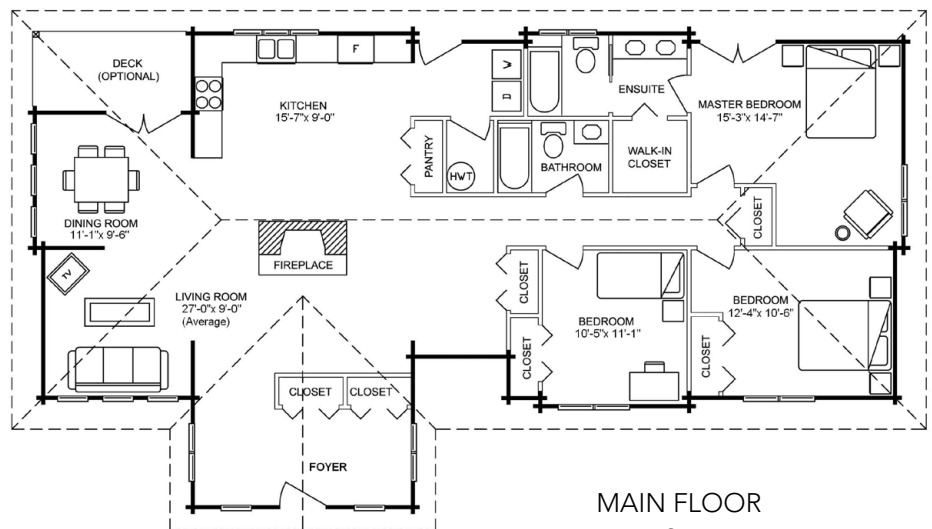

MAIN FLOOR
1,696 square feet (157.54 m²)