



# Galiano

The comforts and conveniences of cottage life are perfectly featured in this well-planned home. Exposed wood beams and vaulted ceilings highlight a floor plan that includes an open kitchen/dining/living room area, a sizeable utility room, two bedrooms and a fully appointed bathroom. A covered porch provides the perfect setting for outdoor entertainment.

Floor Plan:

**Galiano**

Model No:

**5080**

Total Area:

**931 square feet (86.5 m<sup>2</sup>)**

Width:

**30'-2" (9.2 m)**

Depth:

**34'-6" (10.5 m)**

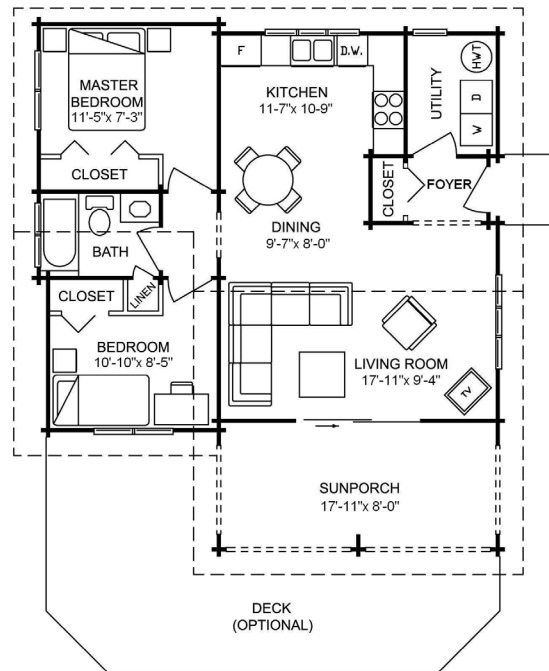

MAIN FLOOR  
931 square feet (86.5 m<sup>2</sup>)